



# FUNCTIONAL SKILLS MATHS & ENGLISH

## LEVEL 1 & 2 EXAMS

### WHO WE ARE

## Leading training company for 26 years

Intech Centre is an established training provider based in Islington, London, with over 26 years of experience in delivering education, employability and digital skills programmes.

Intech Centre specialises in **Functional Skills English and Maths Level 1 & 2**, helping learners successfully pass Level 1 and Level 2 Functional Skills exams required for university entry, apprenticeships, teacher training, nursing courses and many other professional pathways.

Thousands of learners have used our resources, courses and exam services to achieve nationally recognised qualifications.

[BOOK NOW](#)

[LEARN MORE](#)

*\* The materials in this document are the intellectual property of the relevant awarding organisation and are shared for educational and revision purposes only. Intech Centre does not claim ownership of these materials and all rights remain with the respective awarding body.*

### SERVICES

## Courses

- Functional Skills Maths
- Functional Skills English

## Tutoring

- Functional Skills Maths & English Exam Tutoring

## EXAMS

- ➔ Functional Skills **Maths** Level 1 or 2 Exam **in London**
- ➔ Functional Skills **English** Level 1 or 2 Exam **in London**
- ➔ **Online** Functional Skills **Maths** Level 1 or 2 Exam
- ➔ **Online** Functional Skills **English** Level 1 or 2 Exam



[www.intechcentre.com](http://www.intechcentre.com)



362 Essex Road  
Islington N1 3PD



020 7354 5655

**BOOK YOUR FUNCTIONAL SKILLS EXAM NOW!**

## NCFE Level 2 Functional Skills Qualification in Mathematics (603/5060/X)

Paper number: SAM  
Section A: Non-calculator Test



**Time allowed:** 30 minutes

### Learner instructions

- Answer **all** questions.
- Read each question carefully.
- Write your answers in the spaces provided.
- Show your working, as marks may be awarded for working.
- State units in your answers, where appropriate.
- Check your work.

### Learner information

- Section A contains **Activity 1** only.
- The maximum mark for this section is **15**.
- The marks available for **each** question are shown in brackets.

To be completed by the examiner		Mark
A	Activity 1	/ 15
B	Activity 2	/ 15
	Activity 3	/ 15
	Activity 4	/ 15
TOTAL MARK		/ 60

### Resources

You will need a:

- pen, with black or blue ink
- pencil and eraser
- 30 cm ruler
- protractor.

If extra pages are used, please make sure your name and centre name are on them and they are securely fastened to this booklet.

**Please complete the details below clearly and in BLOCK CAPITALS.**

Learner name \_\_\_\_\_

Centre name \_\_\_\_\_

Learner number

Centre number

**Do not turn over until the invigilator tells you to do so.**



SAMPLE

**This page is intentionally left blank.**

## Activity 1: Flat share

1 (a) Alex, Jas and Stef are students. They are looking for a flat to share.

They see these adverts online:

3 bedroom flats in Upton:	3 bedroom flats in Downton:
£433 per month	£368 per month
£450 per month	£425 per month
£395 per month	£412 per month
£475 per month	£330 per month
£389 per month	£447 per month
£375 per month	

What percentage of the flats in Downton cost over £420 per month?

[1 mark]

Your answer:

%

1 (b) They want to know which location is the cheapest.

Use the median monthly rental prices to show which location is the cheapest.

**Show your working.**

[3 marks]

Your answer:

£

Please turn over

1 (c) Alex, Jas and Stef each get a student loan to help with living expenses.

They decide to allocate two fifths of their loans for food, and one-sixth for travel.

What fraction of their student loan will be left to spend?

[2 marks]



Your answer:



1 (d) The students work out that together they have £5400 each year to spend on rent.

They find a flat to rent that will cost £5200 per year.

If the rent **increases by 2%** next year, will it still be within their budget?

**Show your working.**

**[2 marks]**

Working area for the calculation. A large watermark reading "SAMPLE" is visible across this area.

Your answer:

Answer box for the calculation.

**Please turn over**

1 (e) The plan shows a flat the students like.

The living room has a trapezium-shaped bay window.

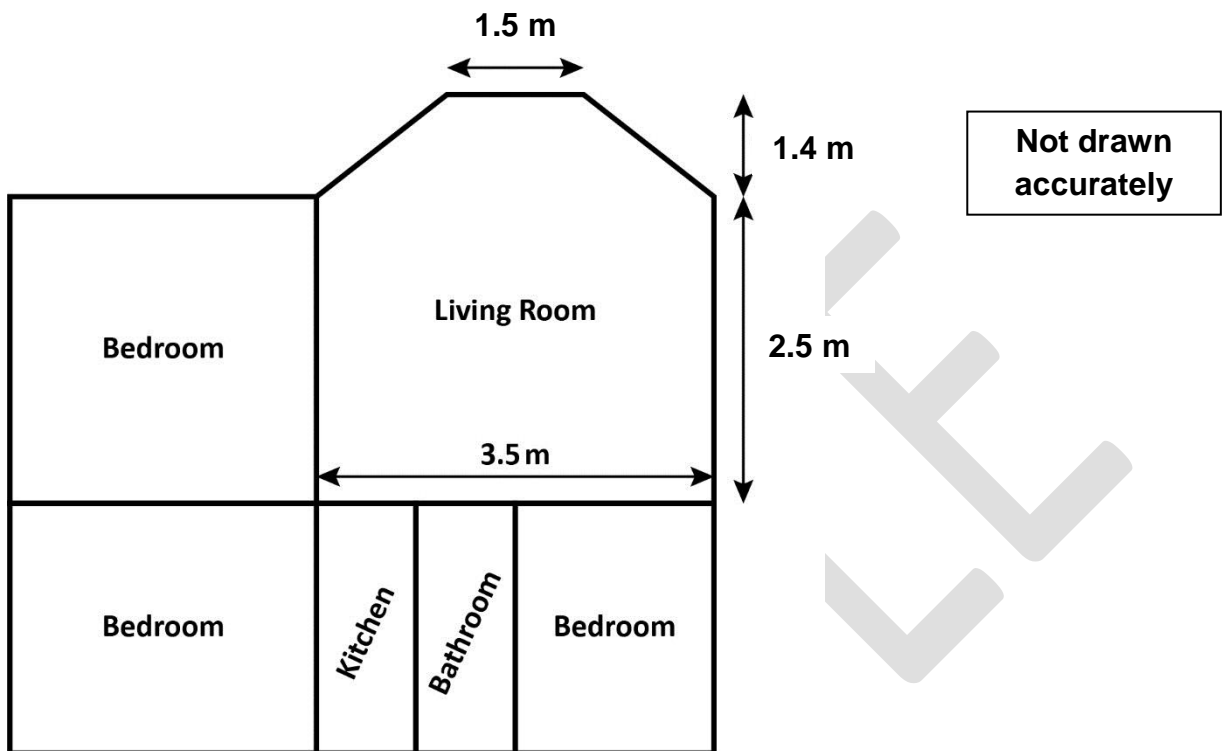

The landlord will replace the carpet in the living room with new flooring, as long as it costs £250 or less.

The new flooring costs £20 per  $\text{m}^2$

The formula for finding the area of a trapezium is:  $\frac{(a+b)}{2} h$

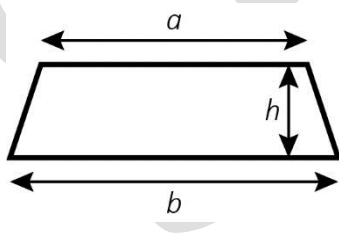

Will the landlord replace the carpet with the new flooring?

**Explain your answer.**

**[4 marks]**

SAMPLE

**Please turn over**

1 (f) Alex, Jas and Stef decide to rent a different 3 bedroomed flat.

They choose their bedrooms.

- Alex's bedroom has an area of  $12 \text{ m}^2$
- Jas's bedroom has an area of  $18 \text{ m}^2$
- Stef's bedroom has an area of  $20 \text{ m}^2$

They decide to share the rent between them:

**Option 1** – Share the rent **equally** between them

**Option 2** – Share the rent **based on the area** of their bedrooms.

Which option will work out cheapest for Jas?

**Show your working.**

[3 marks]

SAMPLE

Your answer:

Option

[Total marks: 15]

**This is the end of Section A.**





# Book Your Functional Skills Exam Now!

Intech Centre is a leading training, careers and examination centre based in Islington, London, delivering Functional Skills Maths and English courses and exams for over 26 years.



**Book Now!**



## Book Your Exams & Courses

Qualification	Private Course	Online Exam	Exam in London
Functional Skills Maths Level 1 & 2	<a href="#">Enrol on Course</a>	<a href="#">Book Online Exam</a>	<a href="#">Book London Exam</a>
Functional Skills English Level 1 & 2	<a href="#">Enrol on Course</a>	<a href="#">Book Online Exam</a>	<a href="#">Book London Exam</a>

## Why Intech Centre?

- Over **26 years' experience** as a UK training and exam centre in London.
- **City & Guilds Functional Skills Maths** and **English exams**, Ofqual regulated and nationally recognised.
- Flexible **online learning** with 24/7 access plus online or centre-based exam options.
- Ideal if you still need GCSE Maths or English equivalent for university entry, teacher training, apprenticeships or employment.

CALL US FOR MORE INFORMATION:



**020 7354 5655**



[www.intechcentre.com](http://www.intechcentre.com)



[info@intechcentre.com](mailto:info@intechcentre.com)