



FUNCTIONAL SKILLS MATHS & ENGLISH

LEVEL 1 & 2 EXAMS

WHO WE ARE

Leading training company for 26 years

Intech Centre is an established training provider based in Islington, London, with over 26 years of experience in delivering education, employability and digital skills programmes.

Intech Centre specialises in **Functional Skills English and Maths Level 1 & 2**, helping learners successfully pass Level 1 and Level 2 Functional Skills exams required for university entry, apprenticeships, teacher training, nursing courses and many other professional pathways.

Thousands of learners have used our resources, courses and exam services to achieve nationally recognised qualifications.

[BOOK NOW](#)[LEARN MORE](#)

** The materials in this document are the intellectual property of the relevant awarding organisation and are shared for educational and revision purposes only. Intech Centre does not claim ownership of these materials and all rights remain with the respective awarding body.*

SERVICES

Courses

- Functional Skills Maths
- Functional Skills English

Tutoring

- Functional Skills Maths & English Exam Tutoring

EXAMS

- ➔ Functional Skills **Maths** Level 1 or 2 Exam **in London**
- ➔ Functional Skills **English** Level 1 or 2 Exam **in London**
- ➔ **Online** Functional Skills **Maths** Level 1 or 2 Exam
- ➔ **Online** Functional Skills **English** Level 1 or 2 Exam



www.intechcentre.com



362 Essex Road
Islington N1 3PD



020 7354 5655

BOOK YOUR FUNCTIONAL SKILLS EXAM NOW!

TQUK Functional Skills Qualification in Maths at Level 2

Examination Past Paper 2

Please complete the details below using black or blue ink. Use **BLOCK CAPITALS**.

Learner Name: _____

Learner Number: _____

Date: _____

Centre Name: _____

Instructions:

- Read each question **carefully**
- Answer **all** questions
- Write your answers **clearly** in the spaces provided
- **Check** your answers.

Information:

- This examination has **two** sections. These are clearly labelled
- You are **not allowed** to use a calculator for Section A
- You **are allowed** to use a basic calculator for Section B
- The **maximum** mark for this examination is 60
- The marks available for each question are shown in **bold** beneath each question.

Items:

- You **will need** a pen with black or blue ink, a pencil, a ruler and an eraser (for diagrams, graphs and charts only)
- You **will need** a basic calculator for Section B only
- You **will need** a protractor and a compass
- You **will not** need any other stationery or equipment.

Time allowed:

30 minutes for Section A (Non-calculator)

90 minutes for Section B (Calculator)

Do not open this examination paper until you are told to do so.

For examiner use only

	Marks available	Marks awarded	Second marks
Section A	15		
Section B	45		
Total marks	60		

This page is intentionally left blank.

Section A: Non-calculator

There are **15 marks** available in this section.
You must **not** use a calculator in this section.
You will have **30 minutes** to complete this section.



1. Work out $9.028 - 0.17$

--

Answer	
--------	--

[1]

2. Work out $24.108 \div 4$

--

Answer	
--------	--

[1]

Questions continue on the following page

3. 50 people are asked what pets they own.

The results are shown below:

	Rabbit	Cat
Dog	16	24
Fish	2	8

One person is chosen at random.

What is the probability that the person chosen has a dog and a cat?

Give your answer as a decimal.

Answer	
---------------	--

[2]

4. The mass of a sphere is 1800 grams (g).

The volume of the sphere is 450 cm^3

Work out the density of the sphere.

Answer	
---------------	--

[2]

5. Jesse is the manager of an aquarium.

The table below shows how many people visited the aquarium over 3 years:

Year	Number of people
2019	568 750
2020	128 528
2021	482 935

Jesse thinks that more than 1 200 000 people visited the aquarium during the 3 years.

Is Jesse correct?

Show how you decide.

Answer

[2]

6. Work out $1.324 + 2.206 + 14.75$

Answer

[2]

Questions continue on the following page

7. Work out:

$$\frac{3}{20} + \frac{17}{15}$$

Give your answer as an improper fraction.

--

Answer

[2]

8. Riley's annual salary is £32 000 before tax.

Riley knows that:

- £12 570 will be tax free
- 20% tax will be deducted from the amount above £12 570

How much will the annual salary be after tax has been deducted?

--

Answer	£
--------	---

[3]

End of Section A.

Section B begins on Page 6.

Section B: Calculator

There are **45 marks** available in this section.

You **can** use a basic calculator in this section.

You will have **90 minutes** to complete this section.

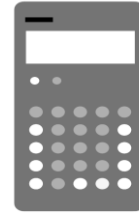

1. Write 13 000 000 000 in words.

Answer

[1]

2. Plot the point $(6, -3)$ on this coordinate grid:

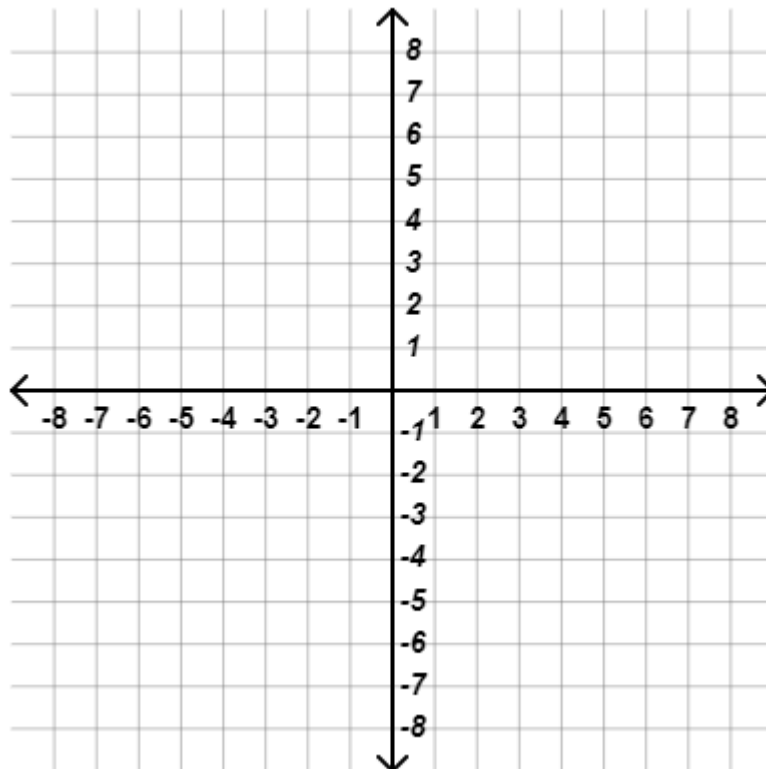

[1]

3. At football training, a footballer has 56 shots at goal and scores 42 times.

The football coach thinks that the footballer scored $\frac{7}{8}$ of the shots.

Has the coach worked out the correct fraction?

Show how you decide.

--

Answer	
---------------	--

[2]

4. Work out:

$$\left(\frac{25 + 5 \times 3}{10^2} \right)$$

Give your answer as a decimal.

--

Answer	
---------------	--

[2]

Questions continue on the following page

5. 3480 people visited a museum in July.
5150 people visited the same museum in August.
Calculate the percentage change in the number of people from July to August.

--

Answer	
---------------	--

Answer	%
---------------	----------

[2]

6. Leslie is planning a road trip.
The scale on the map is 1 : 75 000
The distance Leslie wants to travel represents 11 centimetres (cm) on the map.
Leslie calculates this to be 82.5 kilometres (km).
Is Leslie correct?
Show how you decide.

--

Answer	
---------------	--

[2]

7. Nicky's homemade pillowcases are made using a piece of fabric two metres square.

Each time a pillowcase is made, 0.135 square metres of fabric is wasted.

Nicky wants to **estimate** what percentage of the total fabric is wasted.

Nicky rounds 0.135 to one decimal place.

Using the rounded value, what percentage should Nicky get?

Show your working.

Past Paper	
Answer	%

[3]

Questions continue on the following page

8. Charlie wants to put a safety rope around this pond:

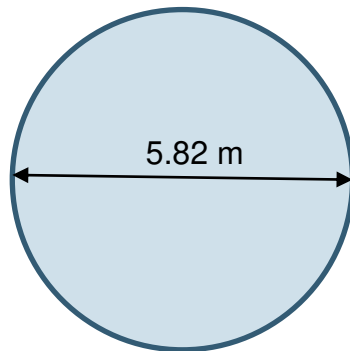

Not drawn to scale

Charlie thinks the total length of rope needed will be more than 18.5 metres (m).

Is Charlie correct?

Show how you decide.

Use $\pi = 3.14$

Answer

[3]

9. Harper paid £12 500 into a new savings account 2 years ago.
The savings account paid 3% compound interest per year.
Harper wants to buy a new car for £18 750
Harper puts all the money in the savings account towards the new car.
How much more money is needed to pay for the car?

Past Paper	
Answer	£

[3]

Questions continue on the following page

10. Alex needs to know what time to leave home to get to a dentist appointment by 10:40 am.

Alex can cycle at an average speed of 12 miles per hour.

The dental surgery is 15 miles from Alex's house.

What is the **latest** time Alex can leave home to cycle to the appointment?

--

Answer

am

[3]

11. Taylor is going to fill a cone with strawberry and vanilla ice-creams.

Taylor will use strawberry and vanilla in the ratio 2 : 3

How much of each flavour will Taylor need?

Use:

$$v = r^2 h$$

Where:

v = volume of cone

r = radius of cone

h = height of cone

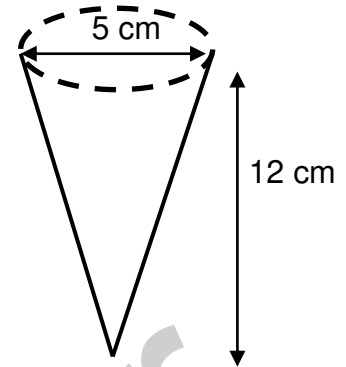

Not drawn to scale

Blank area for student work.

Strawberry		cm ³
Vanilla		cm ³

[4]

Questions continue on the following page

12. Jamie needs to cover this cuboid chest in multi-coloured stickers for an art project:

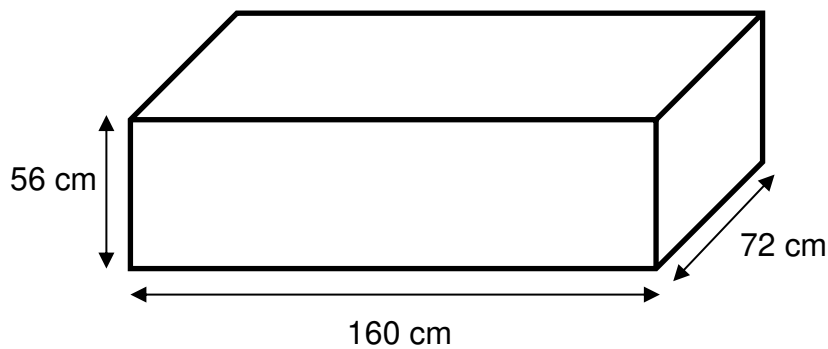

Not drawn to scale

The stickers are in the shape of a square with a side length of 8 cm.

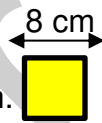

To work out how many stickers are needed, Jamie uses this formula:

$$\text{Total number of stickers} = \frac{\text{Total surface area of chest}}{\text{Area of one sticker}}$$

How many stickers does Jamie need?

Answer

[4]

13. Drew is a gardener.

This table shows how much other local gardeners charge per hour:

Amount (A) charged per hour (£)	Number of gardeners
$20 < A \leq 30$	2
$30 < A \leq 40$	6
$40 < A \leq 50$	8
$50 < A \leq 60$	4
Total	20

Drew wants to charge an hourly rate equal to the estimated mean amount per hour.

How much should Drew charge per hour?

<p style="text-align: right;">Answer £</p>	
---	--

[4]

Questions continue on the following page

14. Ashley wants to paint the wall shown:

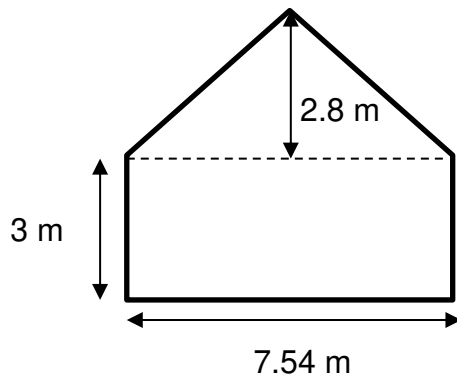

Not drawn to scale

Ashley finds this tin of paint online:

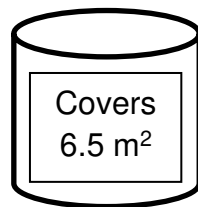

How many tins of paint will Ashley need to buy to paint the wall?

Show your working.

Working area for the student's solution.

Answer

tins

[5]

15. Quinn wants to buy some rope lights to put around a 164 foot section of a garden.

Quinn finds these rope lights online:

Rope light	A	B	C	D	E
Price per metre	£0.60	£1.99	£1.89	£0.75	£0.50

Quinn wants to buy rope lights that are 8% longer than the section of the garden.

Quinn buys the rope lights with the median price.

How much will Quinn pay in total?

Use 1 foot = 0.305 metres

Past paper

Answer £

[6]

This is the end of the assessment.



Book Your Functional Skills Exam Now!

Intech Centre is a leading training, careers and examination centre based in Islington, London, delivering Functional Skills Maths and English courses and exams for over 26 years.



Book Now!



Book Your Exams & Courses

Qualification	Private Course	Online Exam	Exam in London
Functional Skills Maths Level 1 & 2	Enrol on Course	Book Online Exam	Book London Exam
Functional Skills English Level 1 & 2	Enrol on Course	Book Online Exam	Book London Exam

Why Intech Centre?

- Over **26 years' experience** as a UK training and exam centre in London.
- **City & Guilds Functional Skills Maths and English exams**, Ofqual regulated and nationally recognised.
- Flexible **online learning** with 24/7 access plus online or centre-based exam options.
- Ideal if you still need GCSE Maths or English equivalent for university entry, teacher training, apprenticeships or employment.

CALL US FOR MORE INFORMATION:



020 7354 5655



www.intechcentre.com



info@intechcentre.com