



FUNCTIONAL SKILLS MATHS & ENGLISH

LEVEL 1 & 2 EXAMS

WHO WE ARE

Leading training company for 26 years

Intech Centre is an established training provider based in Islington, London, with over 26 years of experience in delivering education, employability and digital skills programmes.

Intech Centre specialises in **Functional Skills English and Maths Level 1 & 2**, helping learners successfully pass Level 1 and Level 2 Functional Skills exams required for university entry, apprenticeships, teacher training, nursing courses and many other professional pathways.

Thousands of learners have used our resources, courses and exam services to achieve nationally recognised qualifications.

[BOOK NOW](#)[LEARN MORE](#)

** The materials in this document are the intellectual property of the relevant awarding organisation and are shared for educational and revision purposes only. Intech Centre does not claim ownership of these materials and all rights remain with the respective awarding body.*

SERVICES

Courses

- Functional Skills Maths
- Functional Skills English

Tutoring

- Functional Skills Maths & English Exam Tutoring

EXAMS

- ➔ Functional Skills **Maths** Level 1 or 2 Exam **in London**
- ➔ Functional Skills **English** Level 1 or 2 Exam **in London**
- ➔ **Online** Functional Skills **Maths** Level 1 or 2 Exam
- ➔ **Online** Functional Skills **English** Level 1 or 2 Exam



www.intechcentre.com



362 Essex Road
Islington N1 3PD



020 7354 5655

BOOK YOUR FUNCTIONAL SKILLS EXAM NOW!

TQUK Functional Skills Qualification in Maths at Level 2

Examination Past Paper 7

Please complete the details below using black or blue ink. Use **BLOCK CAPITALS**.

Learner Name: _____

Learner Number: _____

Date: _____

Centre Name: _____

Instructions:

- read each question **carefully**
- answer **all** questions
- write your answers **clearly** in the spaces provided
- **check** your answers.

Information:

- this examination has **two** sections. These are clearly labelled
- you are **not allowed** to use a calculator for Section A
- you **are allowed** to use a calculator for Section B
- the **maximum** mark for this examination is 60
- the marks available for each question are shown in **bold** beneath each question.

Items:

- you **will need** a pen with black or blue ink, a pencil, a ruler and an eraser (for diagrams, graphs and charts only)
- you **will need** a basic calculator for Section B only
- you **will need** a protractor
- you **will not** need any other stationery or equipment.

Time allowed:

30 minutes for Section A (Non-calculator)

90 minutes for Section B (Calculator)

Do not open this examination paper until you are told to do so.

For examiner use only

| | Marks available | Marks awarded | Second marks |
|-------------|------------------------|----------------------|---------------------|
| Section A | 15 | | |
| Section B | 45 | | |
| Total marks | 60 | | |

This page is intentionally left blank.

Past Paper

Section A: Non-calculator

There are **15 marks** available in this section.
You must **not** use a calculator in this section.
You will have **30 minutes** to complete this section.



1. Work out $1.804 + 2.6$

| |
|--|
| |
|--|

| | |
|--------|--|
| Answer | |
|--------|--|

[1]

2. Work out 5×6.248

| |
|--|
| |
|--|

| | |
|--------|--|
| Answer | |
|--------|--|

[1]

Questions continue on the following page

3. This is a scale diagram of a floor plan of a house:

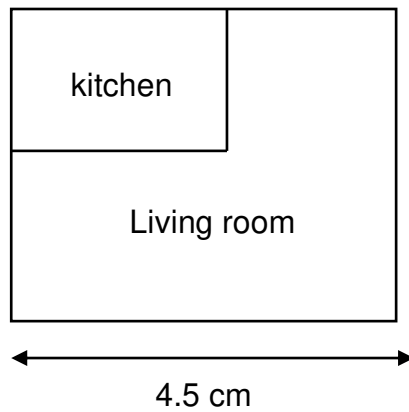

The scale is 1 : 200

Work out the actual length of the living room.

Give the units in your answer.

| | |
|---------------|--|
| | |
| Answer | |

[2]

4. Work out:

$$\frac{1}{4} + \frac{1}{7}$$

| |
|--|
| |
|--|

| | |
|---------------|--|
| Answer | |
|---------------|--|

[2]

5. Charlie receives these discount coupons for the same restaurant:

| |
|------------------------------------|
| Monday $\frac{1}{6}$ off |
|------------------------------------|

| |
|---------------------------|
| Tuesday 16% off |
|---------------------------|

Charlie wants to go to the restaurant on the day which offers the bigger discount.

On which day should Charlie go to the restaurant?

Show how you decide.

| |
|--|
| |
|--|

| | |
|---------------|--|
| Answer | |
|---------------|--|

[2]

Questions continue on the following page

6. Work out the value of angle A.

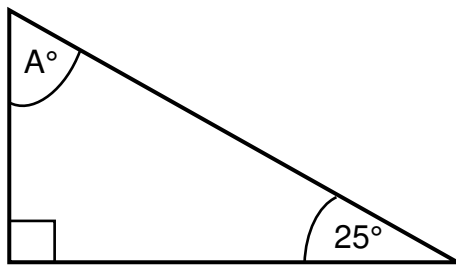

Not drawn to scale

| |
|--|
| |
|--|

Answer

°

[2]

7. A clay pot has:

- mass = 2650 grams
- volume = 1000 cm^3

Work out the density of the clay pot.

| |
|--|
| |
|--|

Answer

[2]

8. Riley wants to become a local football coach.

Riley uses this table to find out how much other local football coaches charge:

| Coach | A | B | C | D | E | F | G |
|-----------------|-----|-----|-----|-----|-----|-----|-----|
| Charge per hour | £25 | £20 | £30 | £40 | £26 | £20 | £35 |

Riley uses this formula to work out how much to charge:

$$P = 1.1M$$

Where:

P is the amount Riley will charge per hour in pounds

M is the mode of the numbers in the table

How much will Riley charge per hour?

| | | |
|--|---------------|---|
| | Answer | £ |
|--|---------------|---|

[3]

End of Section A.

Section B begins on Page 7.

Past Paper

Section B: Calculator

There are **45 marks** available in this section.
 You **can** use a basic calculator in this section.
 You will have **90 minutes** to complete this section.



1. Write five million three hundred thousand in numbers.

| | |
|---------------|--|
| Answer | |
|---------------|--|

[1]

2. Put these numbers in order starting with the lowest:

1 004 682

– 948 750

1 020 845

– 34 589

Show any working here:

| | | | | |
|------------------------|---------------|--|--|----------------|
| Show any working here: | | | | |
| Answer | | | | |
| | Lowest | | | Highest |

[1]

Questions continue on the following page

3. Last week it took 2 gardeners 4 hours to mow a field.
- This week there will be 5 gardeners available to mow a field of the same size.
- The gardeners all work at the same speed.
- Their manager thinks that the 5 gardeners will mow the field in less than 1.5 hours.
- Is the manager correct?
- Show how you decide.**

| | |
|------------|---------------|
| Past Paper | |
| | Answer |

[2]

4. Put these fractions in order starting with the highest:

$2\frac{4}{9}$

$2\frac{5}{6}$

$2\frac{2}{3}$

$2\frac{13}{18}$

Show any working here:

| | | | | |
|---------------|----------------|--|--|---------------|
| Answer | | | | |
| | Highest |  | | Lowest |

[2]

Questions continue on the following page

5. The diagram shows a square based pyramid:

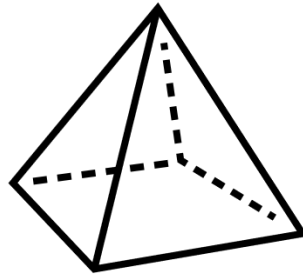

Draw the plan view and side view of the pyramid.

Plan view

Side view

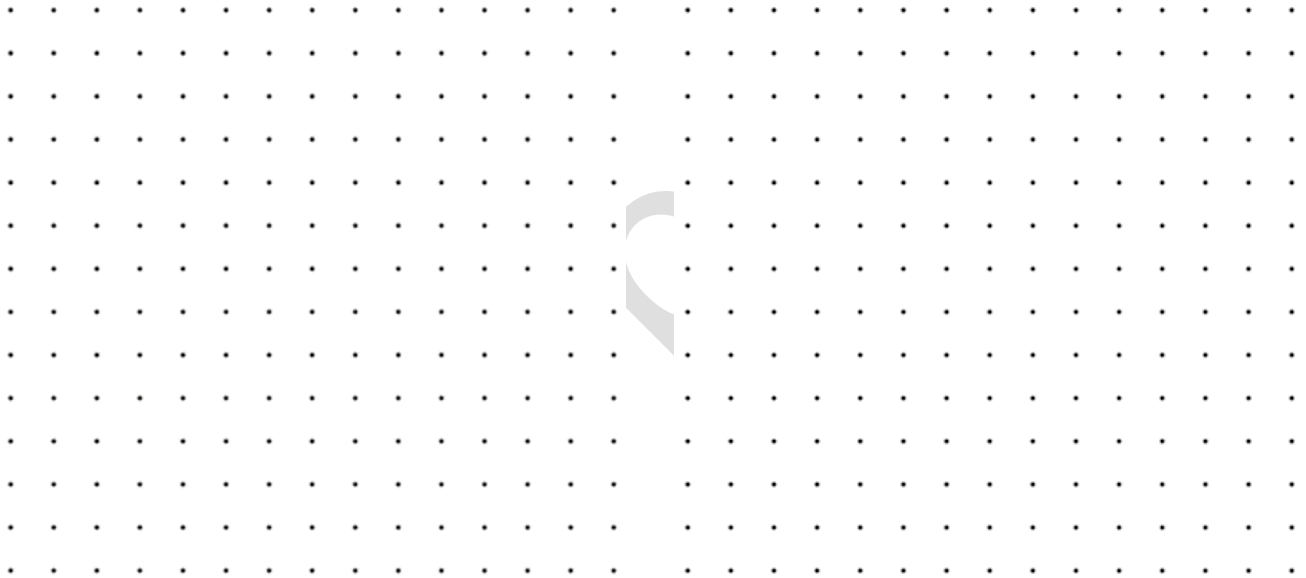

[2]

6. Hansa wants to put a square trampoline in a garden.
One side of the trampoline is shown on this grid:

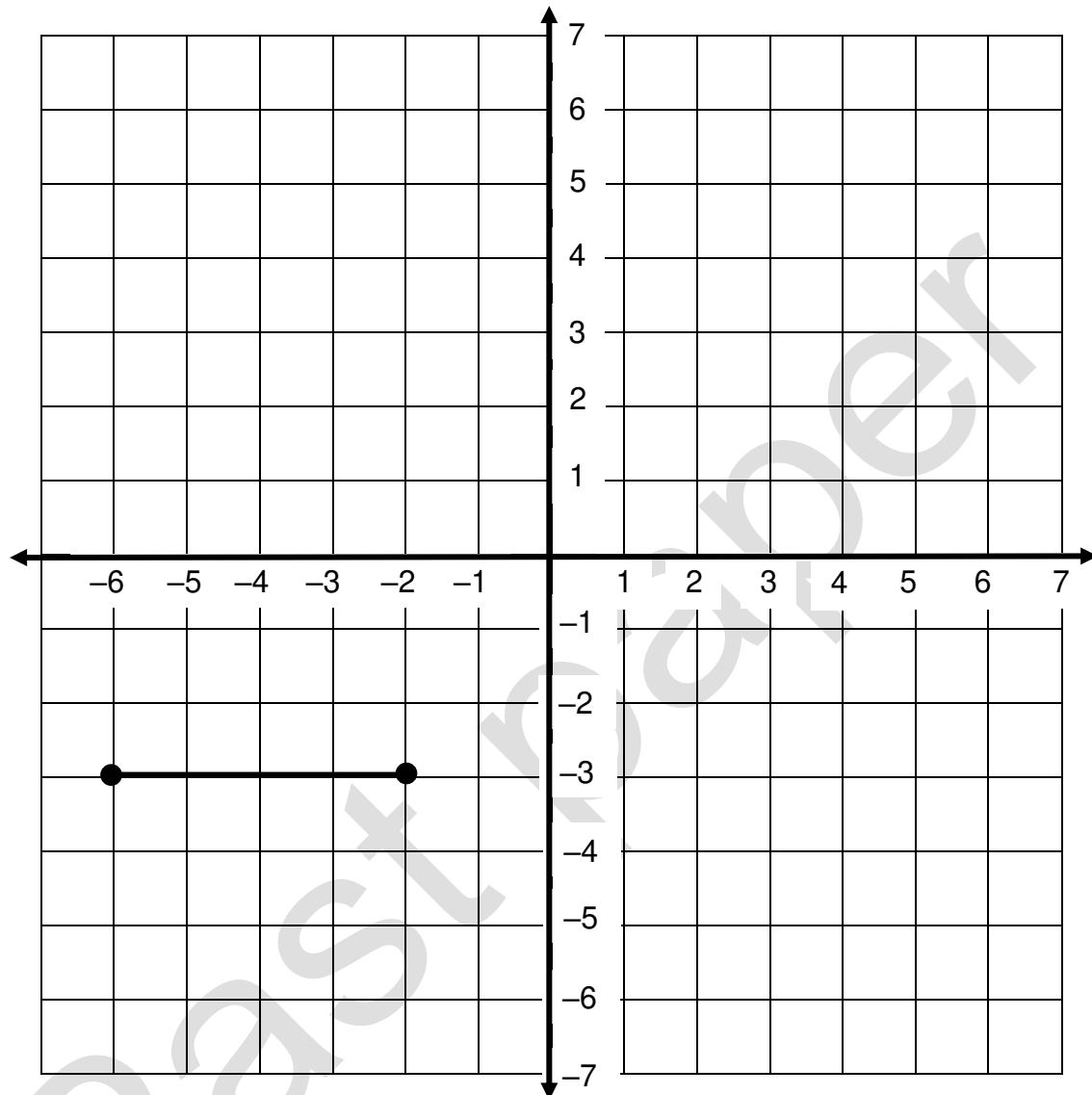

Where could the other **two** corners of the trampoline be placed?

Answer (,) and (,)

[2]

Questions continue on the following page

7. Quinn bought a mobile phone.

The next day, Drew buys the same type of mobile phone in a sale.

Drew got a 32% discount and paid £170 for their phone.

How much more money did Quinn pay for the mobile phone?

| |
|--|
| |
|--|

| | |
|---------------|----------|
| Answer | £ |
|---------------|----------|

[3]

8. This table shows how long Tomi spends on different tasks at work:

| | |
|----------------------|-------------|
| Serving customers | 210 minutes |
| Working in warehouse | 50 minutes |
| Paperwork | 60 minutes |
| Stocking shelves | 100 minutes |

Tomi wants to know what fraction of time is spent doing paperwork.

Tomi works this out to be $\frac{1}{6}$

Has Tomi worked out the correct fraction?

Show how you decide.

Answer area for the question.

Answer

[3]

Questions continue on the following page

9. Bo needs to paint the outside of this cylinder including the top and bottom:

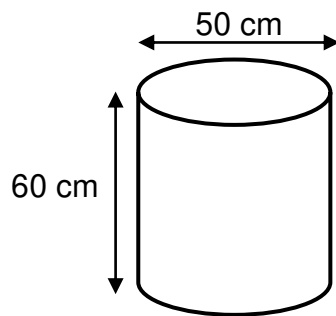

Not drawn to scale

Bo thinks the total area to be painted is less than 15 000 cm²

Is Bo correct?

Show how you decide.

Use $\pi = 3.14$

| |
|--|
| |
|--|

| | |
|---------------|--|
| Answer | |
|---------------|--|

[3]

10. The table shows how far Alex walked each day for two weeks:

| | Monday | Tuesday | Wednesday | Thursday | Friday |
|--------|------------|------------|------------|------------|------------|
| Week 1 | 4 miles | 2 miles | 5 miles | 9 miles | 6 miles |
| Week 2 | 5 miles | 3 miles | 6 miles | 7 miles | 5 miles |

Was Alex more consistent in week 1 or week 2?

Give a reason for your answer.

| | |
|---------------|--|
| Past paper | |
| Answer | |

[3]

Questions continue on the following page

11. Jamie is planning an event for 280 people.

There will be three different ticket types available.

The ticket types are Standard, Premium and Luxury in the ratio 5 : 3 : 2

Jamie needs to know how many of each ticket type there will be.

Complete the table for Jamie.

| Tickets available | |
|-------------------|------------------|
| Ticket Type | Number Available |
| Standard | |
| Premium | |
| Luxury | |
| Total | |

Show any workings here:

| | |
|---------------|--|
| Past paper | |
| Answer | |

[4]

12. Damyan sells cakes in the shape of a cylinder.

The diameter of each cake is 15 centimetres (cm)

Damyan puts a ribbon around the outside of each cake.

Each ribbon needs to be 56% longer than the distance around the cake.

How long does each ribbon need to be?

Use $\pi = 3.14$

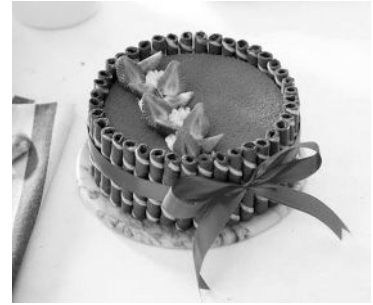

Blank area for writing the answer.

| | | |
|---------------|--|-----------|
| Answer | | cm |
|---------------|--|-----------|

[4]

Questions continue on the following page

13. Riley wants to buy milk from a local farm.

The farm has these prices on its website:

| |
|----------------------|
| Glass bottles |
| £1 per pint |

| |
|-------------------------------|
| Plastic bottles |
| £2.30 for a 2-litre bottle |

Which type of bottle is better value for money?

Use 1 litre = 1.76 pints

Show how you decide.

Answer area for the question. A large watermark "Past paper" is visible diagonally across the page.

| | |
|---------------|--|
| Answer | |
|---------------|--|

[4]

14. Lei needs to paint this wall three times:

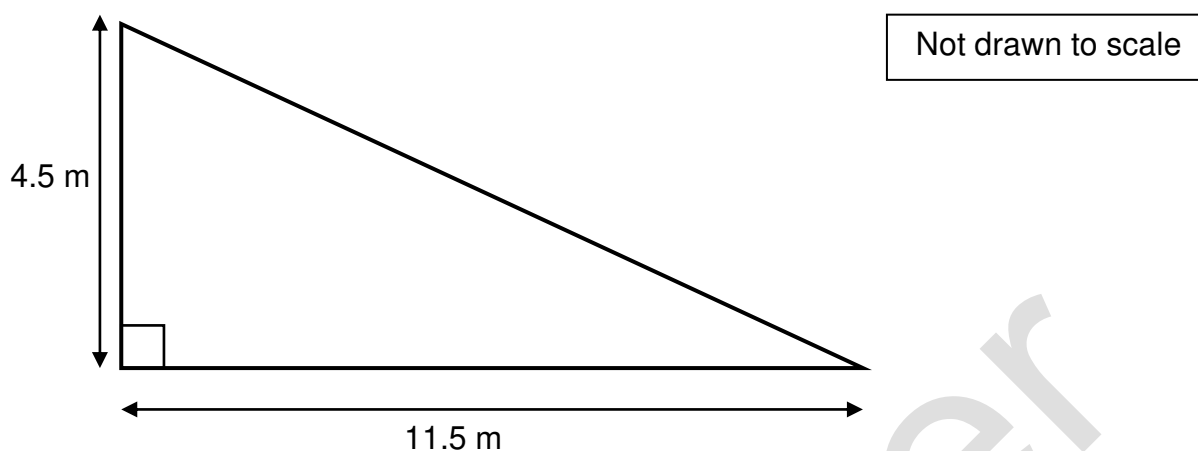

Paint is available in these colours:

| Colour | White | Grey | Black | Charcoal | Cream |
|--|-------------------|-------------------|------------------|------------------|-------------------|
| Number of square metres one tin will cover | 14 m ² | 12 m ² | 8 m ² | 6 m ² | 13 m ² |

Lei chooses the colour that will cover the median number of square metres.

How many tins of paint does Lei need to paint the wall three times?

Show your working.

Answer box is on the following page

| |
|--|
| |
|--|

| |
|---------------|
| Answer |
|---------------|

| |
|------|
| tins |
|------|

[5]

15. Kass owns a cleaning company.

Kass uses this table to record time spent at each cleaning job:

| Time (t) in minutes | Number of cleaning jobs |
|---------------------|-------------------------|
| $0 < t \leq 60$ | 11 |
| $60 < t \leq 120$ | 36 |
| $120 < t \leq 180$ | 18 |
| $180 < t \leq 240$ | 5 |

Kass thinks the mean amount of time per cleaning job is less than 104.75 minutes.

Is Kass correct?

Show your working.

Answer box is on the following page

| |
|--|
| |
|--|

| | |
|---------------|--|
| Answer | |
|---------------|--|

[6]

This is the end of the assessment.

Past Paper



Book Your Functional Skills Exam Now!

Intech Centre is a leading training, careers and examination centre based in Islington, London, delivering Functional Skills Maths and English courses and exams for over 26 years.



Book Now!



Book Your Exams & Courses

| Qualification | Private Course | Online Exam | Exam in London |
|---------------------------------------|---------------------------------|----------------------------------|----------------------------------|
| Functional Skills Maths Level 1 & 2 | Enrol on Course | Book Online Exam | Book London Exam |
| Functional Skills English Level 1 & 2 | Enrol on Course | Book Online Exam | Book London Exam |

Why Intech Centre?

- Over **26 years' experience** as a UK training and exam centre in London.
- **City & Guilds Functional Skills Maths and English exams**, Ofqual regulated and nationally recognised.
- Flexible **online learning** with 24/7 access plus online or centre-based exam options.
- Ideal if you still need GCSE Maths or English equivalent for university entry, teacher training, apprenticeships or employment.

CALL US FOR MORE INFORMATION:



020 7354 5655



www.intechcentre.com



info@intechcentre.com